

REV. A	DATE 2016/12/01	ECN NO. /	MODIFICATION NEW	APPROVER Vicky
--------	-----------------	-----------	------------------	----------------

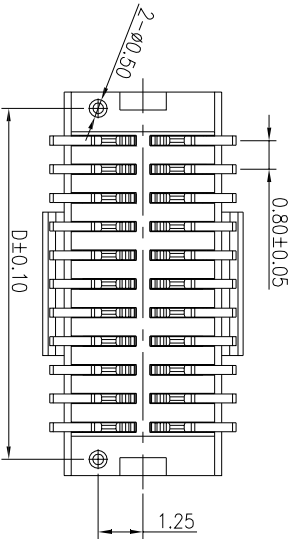
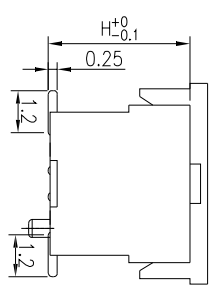
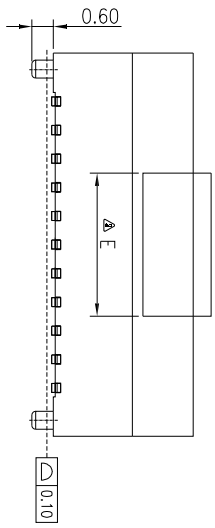
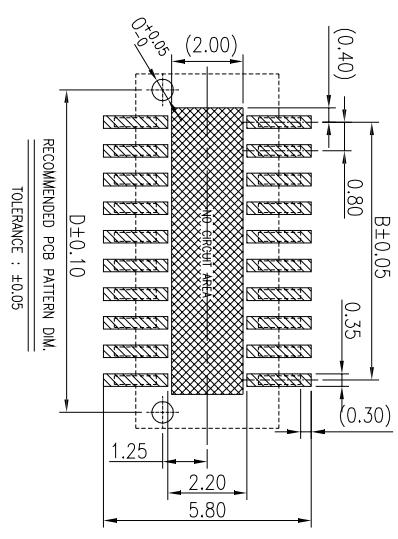
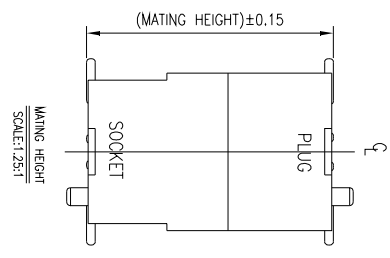
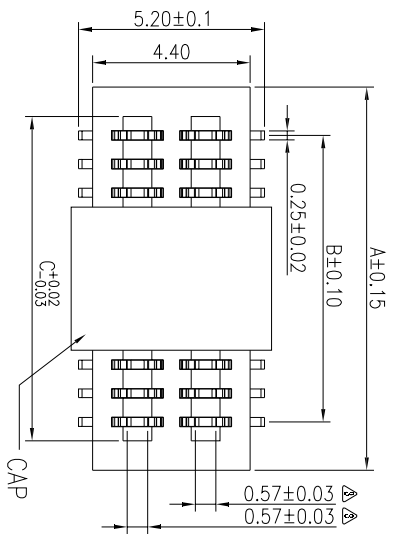

MATING HEIGHT (H)	PLUG (H)	SOCKET (H)
7.0	4.0	3.0
7.5	4.0	3.5
8.0	4.0	4.0
8.5	4.0	4.5

SPECIFICATIONS:
Voltage Rating: 60V DC
Current Rating: 0.5A Max. (Each Pin)
Contact Resistance: 60mΩ MAX
Insulation Resistance: 800MΩ MIN
Dielectric Withstanding : AC 500V
Operating Temperature : -25°C~+85°C
Contact Material: Copper Alloy
Plating Material: Thermoplastic, U194V-0 Black
Lead free and ROHS compliant product

No. of contact	Dimensions				
	A	B	C	D	E
4	3.50	0.80	1.86	2.80	
6	4.30	1.60	2.66	3.40	
8	5.10	2.40	3.46	4.20	
10	5.90	3.20	4.26	5.00	4.00
12	6.70	4.00	5.06	5.80	
14	7.50	4.80	5.86	6.60	
16	8.30	5.60	6.66	7.40	
18	9.10	6.40	7.46	8.20	
20	9.90	7.20	8.26	9.00	
22	10.70	8.00	9.06	9.80	
24	11.50	8.80	9.86	10.60	
26	12.30	9.60	10.66	11.40	
28	13.10	10.40	11.46	12.20	
30	13.90	11.20	12.26	13.00	
32	14.70	12.00	13.06	13.80	
34	15.50	12.80	13.86	14.60	8.00
36	16.30	13.60	14.66	15.40	
38	17.10	14.40	15.46	16.20	
40	17.90	15.20	16.26	17.00	
42	18.70	16.00	17.06	17.80	
44	19.50	16.80	17.86	18.60	
46	20.30	17.60	18.66	19.40	
48	21.10	18.40	19.46	20.20	
50	21.90	19.20	20.26	21.00	
54	23.50	20.80	21.86	22.60	
56	24.30	21.60	22.66	23.40	
58	25.10	22.40	23.46	24.20	
60	25.90	23.20	24.26	25.00	
62	26.70	24.00	25.06	25.80	
64	27.50	24.80	25.86	26.60	
66	28.30	25.60	26.66	27.40	
68	29.10	26.40	27.46	28.20	
70	29.90	27.20	28.26	29.00	
72	30.70	28.00	29.06	29.80	
74	31.50	28.80	29.86	30.60	
76	32.30	29.60	30.66	31.40	
78	33.10	30.40	31.46	32.20	
80	33.90	31.20	32.26	33.00	8.00
82	34.70	32.00	33.06	33.80	
84	35.50	32.80	33.86	34.60	
86	36.30	33.60	34.66	35.40	
88	37.10	34.40	35.46	36.20	
90	37.90	35.20	36.26	37.00	
92	38.70	36.00	37.06	37.80	
94	39.50	36.80	37.86	38.60	
96	40.30	37.60	38.66	39.40	
98	41.10	38.40	39.46	40.20	
100	41.90	39.20	40.26	41.00	

GENERAL TOLERANCE			UNITS	NAME:	TITLE:	
SELECT	✓		mm	BTB	Customer drawing for	
TOL	1	2		PART NO:	BTB0.8mm 2*XP 双槽 母座 带定位柱	
ON	±0.02	±0.05		BTB080***-F1D****	ATOM—A03736	
X.XXX	±0.05	±0.13		APPD:	DWG NO.	
X.XX	±0.05	±0.13		Jason	ATOM—A03736	
X.X	±0.10	±0.25		CHKD:	SCALE	
X	±0.38	±1.00		Vicky	SHEET	
ANGLE	±1°			DR:	1/1	
				Cmy	REV	
					A	

ATOM 深圳市爱特姆科技有限公司
SHENZHEN ATOM TECHNOLOGY CO., LTD.

1 2 3 4 5 6 7 8