

REV.	DATE	ECN NO.	MODIFICATION	APPROVER
A0	2024.03.10	/	NEW	Abel

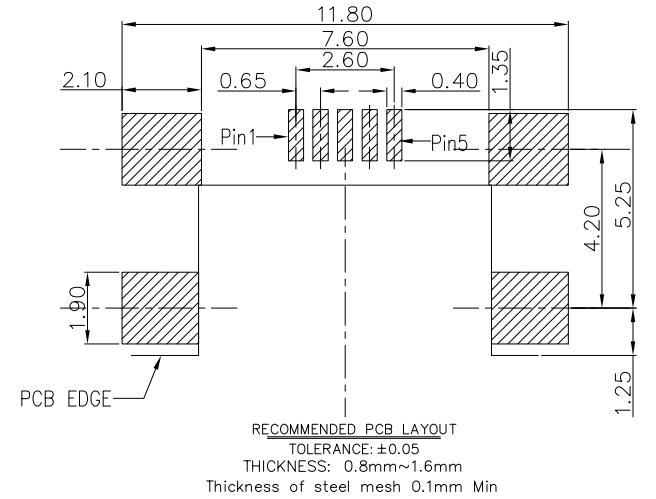

- Note:
- Material:
 - Housing: LCP, UL94V-0 Color: Black
 - Contact: C5191
Gold Flash plating at contact
50u" Min Nickel under plating over all
 - Shell: SUS304,
Matte Tin 50u" plated over Nickel 50u"
 - Electrical:
 - Current Rating: 1.5PIN 1.8A Max
2.3.4PIN 1A Max
 - Voltage Rating: 5V
 - Contact Resistance: 30mΩ Max
 - Dielectric withstanding voltage: 100V AC
 - Insulation Resistance: 100MΩ Min
 - Mechanical characteristics:
 - Insertion Force: 3.57 kgf Max
 - Extraction Force: 1.0 kgf Min
 - Durability: 3000 cycles
 - Environment characteristics:
 - Operating Temperature: -30~+80°C
- Major Dimension: ▽
Products meet RoHS environmental requirements

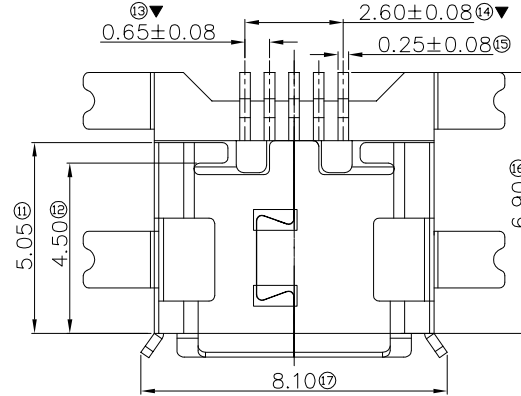
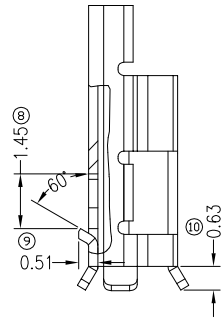
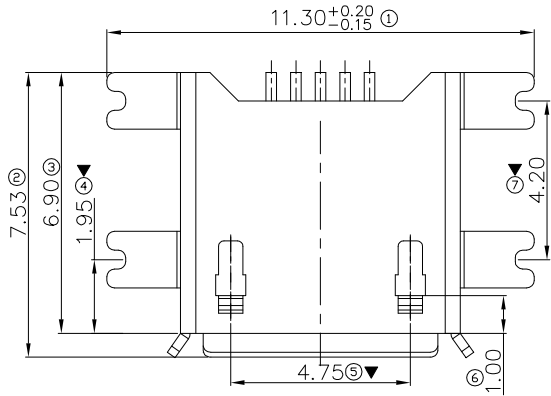
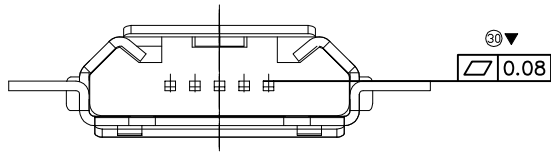
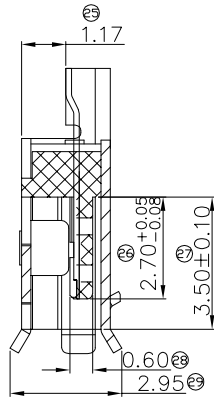
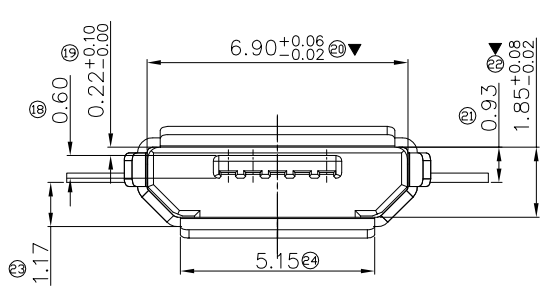

USB205FB-C1067301

- | | |
|-------------------|----------------------------|
| 产品代码: USB | 流水码 |
| 产品类别代码: MICRO USB | 1: 管装; 2: 卷装; 3: 盘装; 4: 袋装 |
| PIN 数代码 | 产品特性: 外壳四脚贴板 |
| F: 母座; M: 公座 | 1: 单排; 2: 双排 |
| 产品型号 | 焊接特性: SMT 卧式 |

GENERAL TOLERANCE			UNITS	NAME (INTENDED USE)	ATOM 深圳市爱特姆科技有限公司 SHENZHEN ATOM TECHNOLOGY CO., LTI
SELECT	✓		mm	USB	
TOL.	1	2	MAT'L	PART NO. (INTENDED USE)	TITLE: Customer Drawing For MICRO USB 5P FEMALE 卧式 SMT B TYPE 四脚贴板 不锈钢 破板式 1.17 有导位
ON.	1	2	FINISH	USB205FB-C1067301	APPD: Abel
X.XXX	±0.10	±0.15	Q'TY	CHKD: Vicky	DWG NO.: ATOM-A12344
X.XX	±0.15	±0.20		DR: XCF	
X.X	±0.20	±0.25			
X.	±0.25	±0.30			
ANGLE	±2'				

SCALE	SHEET	REV.
1:1	1/1	A0