

HF

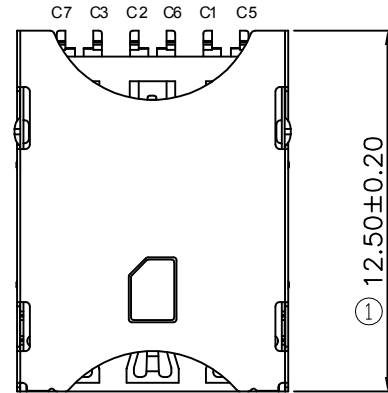

0.34^{+0.15}_{-0.00}(M)

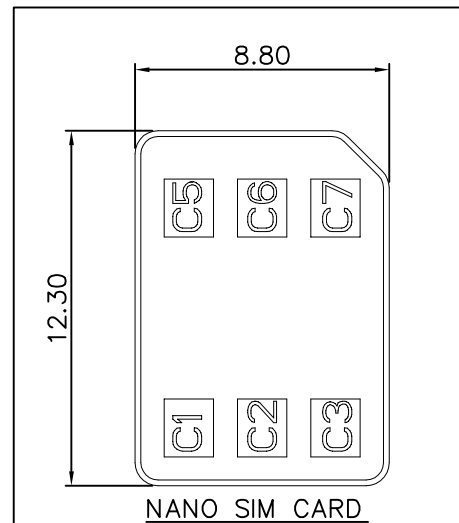
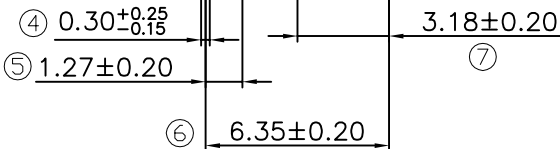
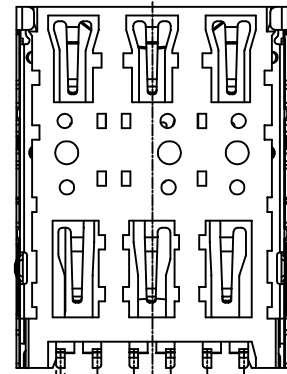
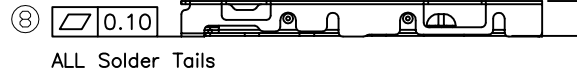
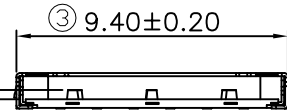

REV.	DATE	ECN NO.	MODIFICATION	APPROVER
AO	2023.12.25	/	NEW	Abel

NOTES:

1. MATERIAL:
 - Housing: LCP ,Black UL94V-0
 - Terminal:C5210,T=0.10mm
 - Gold Flash on contact area,
 - 100u" Tin Plated on Solder area
 - Shell: SUS304 T=0.10mm
 - Nickel Plating 50u" Min
 - Halogen Free and Rohs compliant product

2. Electrical
 - Rated Current:1.0 A
 - Rated Voltage:15V
 - Ambient Temperature Range: -25°C~+85°C
 - Ambient Humidity Range :95% R.H. Max.
 - Contact Resistance:100mΩ Max
 - Insulation Resistance:500MΩ Min
 - Dielectric Withstanding Voltage:500V AC For one minuate
 - Durability:1500 cycles
 - Temperature 260±5°C,

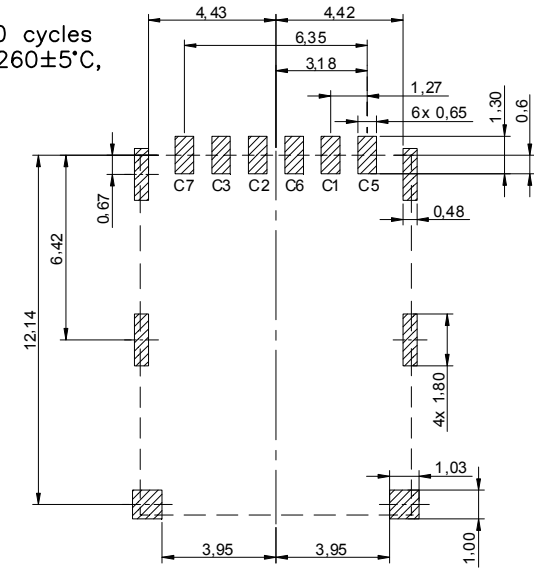

RECOMMENDED PCB LAYOUT

GENERAL TOLERANCE±0.05

GENERAL TOLERANCE			UNITS mm	NAME(INTENDED USE) NANO SIM CARD	深圳市爱特姆科技有限公司 SHENZHEN ATOM TECHNOLOGY CO., LTD.
SELECT		✓			
TOL.	1	2	3	FINISH	TITLE: NANO SIM CARD 6PIN H=1.20 通用型
X.XXX	±0.10	±0.15	±0.20	Q'TY	APPD:
X.XX	±0.15	±0.20	±0.25		CHKD:
X.X	±0.20	±0.25	±0.30		DR:
X.	±0.25	±0.30	±0.50		DWG NO.:
ANGLE	±2'				ATOM-A09270
					SCALE: 1:1 SHEET: 1/1 REV: AO