

| | | | |
|-----|------------|--------------|----------|
| REV | DATE | MODIFICATION | APPROVER |
| A0 | 2023.04.14 | NEW | ABEL |
| | | | |
| | | | |

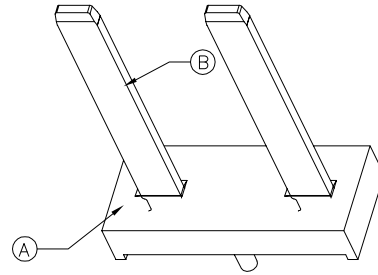

3D示图 (SCALE .1:1)

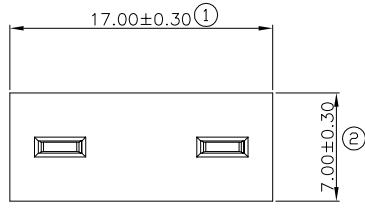
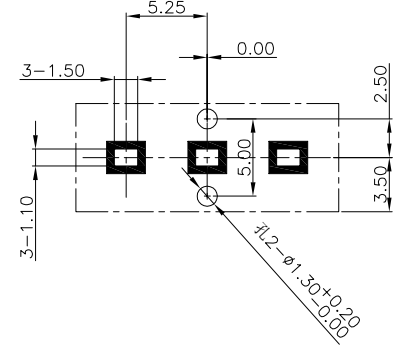
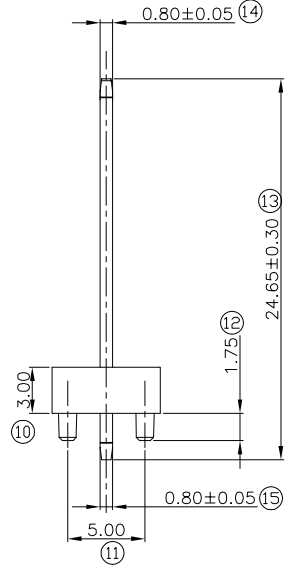
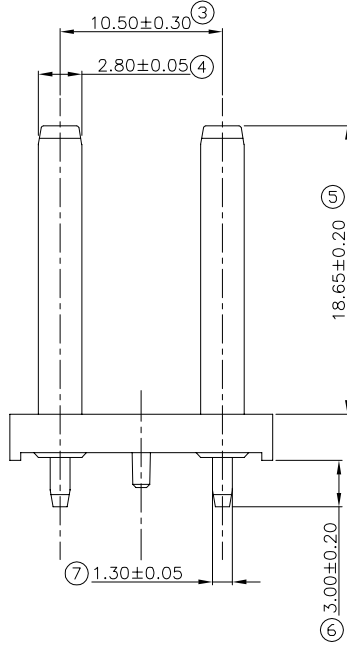

RECOMMENDED PCB LAYOUT
TOLERANCE: ±0.05
THICKNESS: 0.8mm~1.6mm

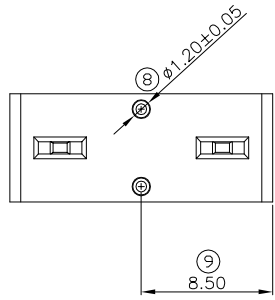

SPECIFICATION

- Electrical and environment performance
 - Current rating:13A/MAX
 - Insulation resistance:1000MΩ Min. at 500V DC.
 - Terminal contact resistance:30mΩ Max.
 - Withstanding voltage:500V(r.m.s.)AC at 1mA Max. for one minute
 - Operating temperature: -30℃~ +105℃
- Packing Regulation:TUBE

| NO. | DESCRIPTION | MATERIAL | COLOR | REMARK | SURFACE TREATMENT |
|-----|-------------|----------------------|-------|--------------|-------------------------|
| ② | TERMINAL | COPPER ALLOY T0.80mm | | SEE PART NO. | TIN .OVER NICKEL PLATED |
| ① | HOUSING | THERMOPLASTICS:LCP | BLACK | UL94V-0 | |

| GENERAL TOLERANCE | | | |
|-------------------|-------|-------|-------|
| SELECT | TOL. | 1 | 2 |
| DN. | | 1 | 2 |
| X.XXX | ±0.10 | ±0.05 | ±0.15 |
| X.XX | ±0.15 | ±0.13 | ±0.25 |
| X.X | ±0.20 | ±0.25 | ±0.5 |
| X. | ±0.30 | ±0.38 | ±1.00 |
| ANGLE | ±2° | | |

| | |
|--------|----|
| UNITS | mm |
| MAT'L | |
| FINISH | |
| Q'TY | |

| | |
|----------|--------------------------|
| NAME: | PH10.5mm 2pin排针 DIP 180° |
| PART NO: | PH105002B-09300 |
| APPD: | |
| CHKD: | ABEL |
| DR: | TOM |

| | | | |
|--|-------|--------|-----|
| ATOM 深圳市爱特姆科技有限公司 SHENZHEN ATOM TECHNOLOGY CO., LTD. | | | |
| TITLE: CUSTOMER DRAWING FOR PH10.5mm 2pin排针 DIP 180° 带定位柱 | | | |
| DWG NO. ATOM-A07972 | | | |
| | SCALE | SHEET | REV |
| | 1:1 | 1 OF 1 | A0 |