

REV	DATE	MODIFICATION	APPROVER
A0	2017.09.25	NEW	Jason

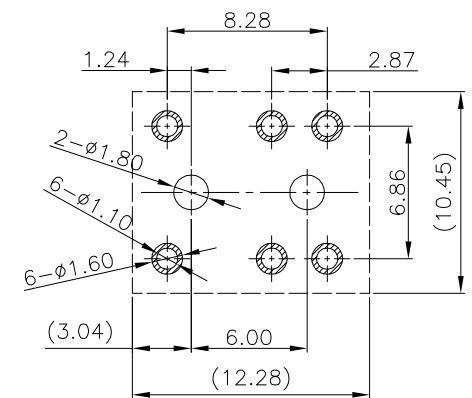

RECOMMENDED P.C BOARD LAYOUT (TOP VIEW)  
TOLERANCES UNLESS OTHERWISE SPECIFIED ±0.05  
PAD AREA

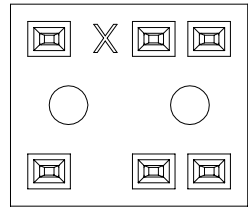
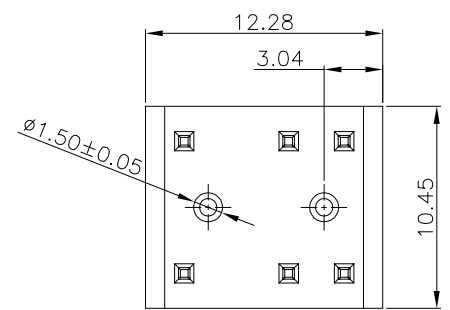
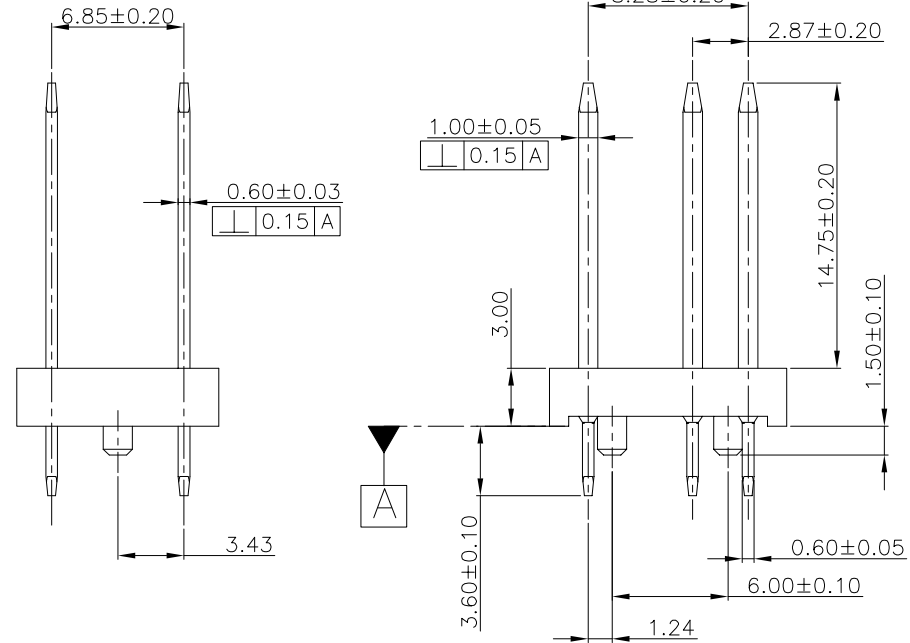
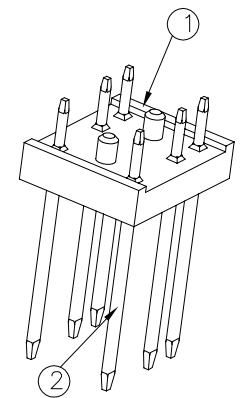

SPECIFICATION

- Electrical and environment performance
  - Current rating:4A
  - Insulation resistance:100MΩ Min. at 500V DC(After Testing)
  - Terminal contact resistance:30mΩ Max.
  - Withstanding voltage:500V(r.m.s.)AC at 1mA Max. for one minute
  - Operating temperature: -20℃~ +80℃
- Packing Regulation:TUBE

②	TERMINAL	COPPER ALLOY		SEE PART NO.
①	HOUSING	THERMOPLASTICS	BLACK	UL94V-0
NO.	DESCRIPTION	MATERIAL	COLOR	REMARK

GENERAL TOLERANCE		UNITS	NAME:		深圳市爱特姆科技有限公司		
SELECT	TOL.	mm	PH2.87*3.0 2*3P DIP 180°		SHENZHEN ATOM TECHNOLOGY CO.,LTD.		
DN.	1 2 3		L=21.35/3.0/14.75 带定位柱		TITLE: PH2.87*3.0 2*3P DIP 180°		
X.XXX	±0.10±0.05±0.15		PART NO: PH287006D-14101		L=21.35/3.0/14.75 带定位柱		
X.XX	±0.15±0.13±0.25		APPD: Jason		DWG NO. ATOM-A03641		
X.X	±0.20±0.25±0.5		CHKD:		SCALE SHEET REV		
X.	±0.30±0.38±1.00		DR: LiuDan 2017.09.25		1:1 1 OF 1 A		
ANGLE	±2°						