

REV.	DATE	ECN NO.	MODIFICATION	APPROVER
A0	2022.05.26	/	NEW	Abel

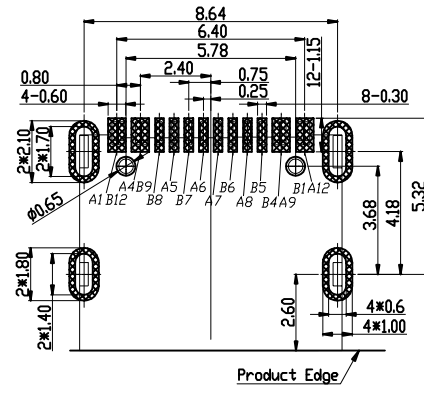
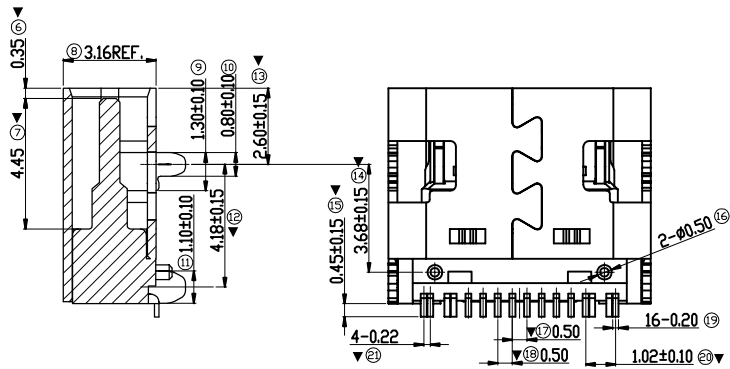
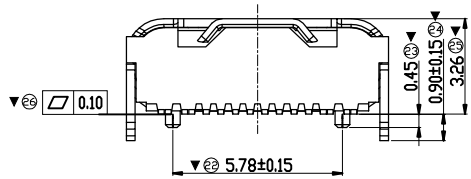
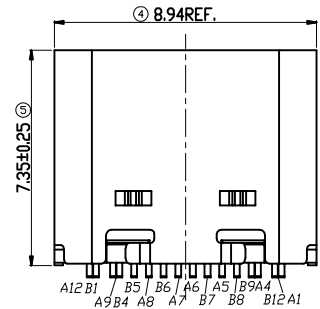
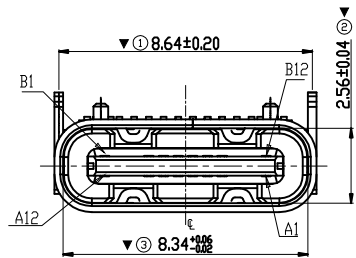

RECOMMENDED P.C.B. LAYOUT (T:1.00mm)
TOLERANCE UNSPECIFIED ±0.05mm

- Note:
- Material:
 - Housing: LCP UL94V-0. Black
 - Contact: C2680
Au 1u" plated on contact area.
Sn 60~120u" plated on solder area,
Ni 50u" under plated over all.
 - Shell: SUS304
Ni 50u" under plated over all.
 - Couple: SUS304.
 - Electrical:
 - Current Rating: 3.0A
 - Voltage Rating: 20V DC
 - Contact Resistance: 40mΩ Max.
 - Insulation Resistance: 150V DC/100MΩ MIN
 - Dielectric Withstanding Voltage: 150V AC/ 1 mA MAX
 - Mechanical characteristics:
 - Insertion Force: 5~20N.
 - Extraction Force: 8~20N.
 - Durability: 10000 cycles
 - Environment characteristics:
 - Operating Temperature: -25~+85°C
- Major Dimension: ▼
Products meet ROHS environmental requirements

GENERAL TOLERANCE				UNITS	mm	NAME (INTENDED USE)	ATOM® 深圳市爱特姆科技有限公司 SHENZHEN ATOM TECHNOLOGY CO., LTD.	
SELECT	TOL	1	2					3
A1	GND	B12	GND	MAT'L	mm	USB	TITLE: Customer Drawing For USB TYPE-C 16P FEMALE SMT 单排 带柱 外壳四脚插板 无弹 L=7.35 (电流3A)	
A4	VBUS	B9	VBUS					
A5	CC1	B8	SBUS2			PART NO. (INTENDED USE)		DWG NO.:
A6	D+	B7	D-			USB616FC-C2014240		ATOM-A08624
A7	D-	B6	D+			APPD: Abel		CHKD: Vicky
A8	SBUS1	B5	CC2			DR: xh		SCALE
A9	VBUS	B4	VBUS			1:1		SHEET
A12	GND	B1	GND			1/1		REV.
PIN	SIGNAL NAME	PIN	SIGNAL NAME			±2'		A0